

NOTES / REVISIONS

This drawing must not be scaled.
All dimensions to be checked on site
by the Contractor and any
discrepancies to be reported back to
the Architect / C.A. before work
commences.

KEY:

- D140 Door number in Base Scheme
- D162 Door number in Option 5 Scheme
- A1024 Existing room number
- 1-024 New room number

KEY

- EXG PARTITION RETAINED
- EXG PARTITION REMOVED
- NEW PLASTERBOARD PARTITION
- DG12 DOOR NUMBER
- DETAIL REFERENCE
- DRAWING NUMBER
- 600X600mm EXTRACT GRILLE
- VENTILATION GRILLE
- COOLPHASE CEILING DIFFUSER
- CEILING SWIRL DIFFUSER
- 600X600 RECESSED LED REFLECTOR
- 300X300mm EXTRACT GRILLE
- SUPPLY AIR DIFFUSER
- SUSPENDED LUMINARIES
- SURFACE MOUNTED 600mm DIA LUMINARIES
- RECESSED 150mm DIA DOWNLIGHT
- SMOKE DETECTOR/SOUNDER
- FIRE ALARM
- HEAT DETECTOR

shaded areas are not
part of this Option

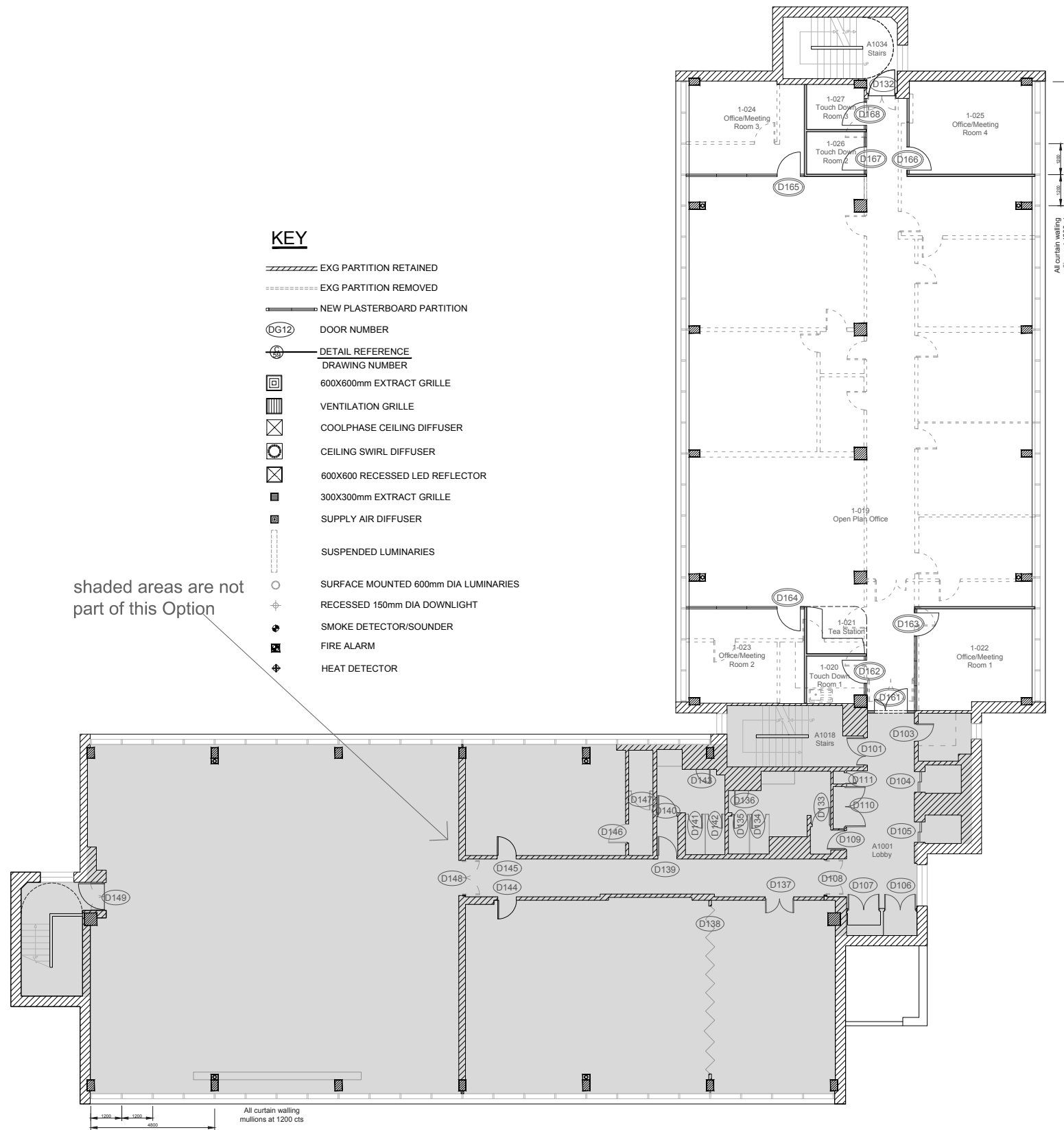

A - 26May16 - Notes added - PDW

no:	Revision	Date:
-----	----------	-------

STEVENAGE BOROUGH COUNCIL
Keith Brown BSc Dip Arch
Head of Property & Estates Services,
Daneshill House,
Danestrete,
Stevenage,
Herts, SG1 1HN.
Telephone: (01438) 242242

PROJECT: REFURBISHMENT OF
COUNCIL OFFICES, GERNON ROAD
LETCHWORTH GARDEN CITY

FOR NORTH HERTFORDSHIRE
DISTRICT COUNCIL

DRAWING: OPTION 5
PROPOSED
FIRST FLOOR PLAN
NORTH BLOCK

DRAWN BY: PDW	CHECKED:
------------------	----------

DATE: **Apr 2016**

SCALE: **1:100 @ A1**

DRAWING
NUMBER: **3000-C-002-120 A**